

**2015  
Camry  
Quick Reference Guide**

# 2015 Camry

This *Quick Reference Guide* is a summary of basic vehicle operations. It contains brief descriptions of fundamental operations so you can locate and use the vehicle's main equipment quickly and easily.

The *Quick Reference Guide* is not intended as a substitute for the *Owner's Manual* located in your vehicle's glove box. We strongly encourage you to review the *Owner's Manual* and supplementary manuals so you will have a better understanding of your vehicle's capabilities and limitations.

Your dealership and the entire staff of Toyota Motor Sales, U.S.A., Inc. wish you many years of satisfied driving in your new Camry.

## A word about safe vehicle operations

This *Quick Reference Guide* is not a full description of Camry operations. Every Camry owner should review the *Owner's Manual* that accompanies this vehicle.

Pay special attention to the boxed information highlighted in color throughout the *Owner's Manual*. Each box contains safe operating instructions to help you avoid injury or equipment malfunction.

All information in this *Quick Reference Guide* is current at the time of printing. Toyota reserves the right to make changes at any time without notice.

## INDEX

### OVERVIEW

Engine maintenance	9
Fuel tank door release and cap	8
Hood release	9
Indicator symbols	4-5
Instrument cluster	4
Instrument panel	2-3
<b>Keyless entry<sup>1,2</sup></b>	<b>6</b>
Light control-Instrument panel	8
<b>Smart Key System<sup>1,2</sup></b>	<b>7</b>

### FEATURES/OPERATIONS

Air Conditioning/Heating	18-19
Audio	21
<b>Auto lock/unlock<sup>1,2</sup></b>	<b>10</b>
Automatic Transmission	10
<b>Bluetooth® Device Pairing Section</b>	<b>29-38</b>
Bottle holders	23
BSM (Blind Spot Monitor)	17
Clock	18
Cruise control	16
Cup holders	23
Garage door opener (HomeLink®) <sup>3</sup>	16
iPod®/USB/AUX port	22
<b>Lights<sup>1</sup> &amp; turn signals</b>	<b>15</b>

Lane Departure Alert (LDA)	25
Moonroof	12
<b>Multi-Information Display<sup>1</sup></b>	<b>24</b>
Parking brake	11
Power outlets-12V DC	14
PCS (Pre-collision system)	25
Rear view monitor system	17
Seat adjustments-Front	13
Seat adjustments-Rear	13
Seat heaters	19
Seats-Head restraints	12
Steering lock release	11
Steering wheel switches and Telephone controls (Bluetooth®)	20
Tilt and telescopic steering wheel	11
Traffic	22
Weather	22
Windows-Power	12
Wipers & washers	14
Wireless Charging	24

### SAFETY AND EMERGENCY FEATURES

Door locks	24
Doors-Child safety locks	24
Floor mat installation	28
Safety Connect	25
Seat belts	24
Seat belts-Shoulder belt anchor	25
Spare tire & tools	26
Star Safety System™	27-28
Trunk internal release	26

<sup>1</sup> Visit your Toyota dealer for information on customizing this feature.

<sup>2</sup> Programmable by customer. Refer to the Owner's Manual for instructions and more information.

<sup>3</sup> HomeLink® is a registered trademark of Gentex Corporation.

# OVERVIEW

## Instrument panel

### Steering wheel controls

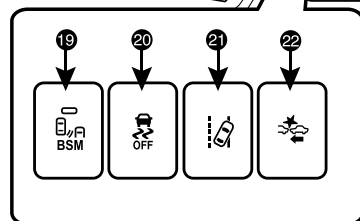
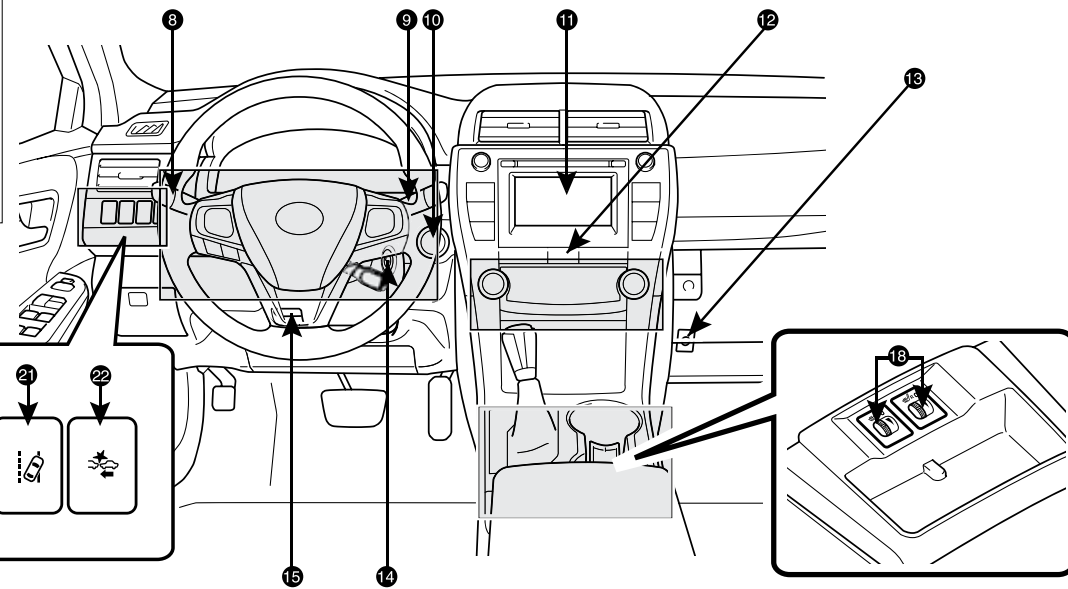
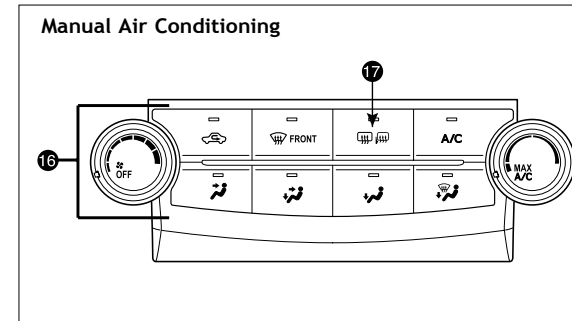
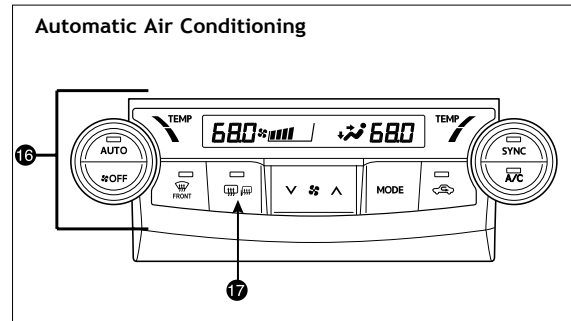
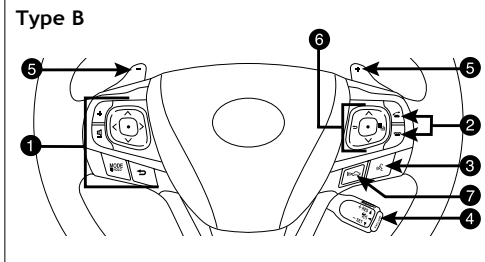
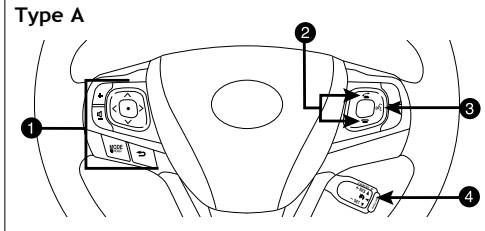

- ① Steering wheel audio controls<sup>1,2,3</sup>
- ② Telephone controls<sup>1,2,3</sup>
- ③ Voice command button<sup>1,2,3</sup>
- ④ Cruise control
- ⑤ Paddle shift switches<sup>1</sup>
- ⑥ Meter control switches<sup>1</sup>
- ⑦ Vehicle-to-vehicle distance button<sup>1</sup>
- ⑧ Headlight and turn signal controls/Headlight, turn signal and front fog light<sup>1</sup> controls
- ⑨ Wiper and washer controls
- ⑩ “ENGINE START STOP” button (Smart Key)<sup>1</sup>
- ⑪ Audio system<sup>1</sup>/Navigation system<sup>1,2</sup>/Display audio system<sup>1,3</sup>
- ⑫ Emergency flasher button
- ⑬ Tire pressure warning reset switch<sup>1</sup>
- ⑭ Key ignition
- ⑮ Tilt and telescopic steering lock release

- ⑯ Air Conditioning controls
- ⑰ Outside rearview mirror<sup>1</sup>/Rear window defogger button
- ⑱ Seat heater controls<sup>1</sup>
- ⑲ BSM (Blind Spot Monitor) main switch<sup>1</sup>
- ⑳ VSC OFF switch
- ㉑ LDA (Lane Departure Alert) switch<sup>1</sup>
- ㉒ PCS (Pre-Collision System) switch<sup>1</sup>

<sup>1</sup> If equipped

<sup>2</sup> For details, refer to the “Navigation System Owner’s Manual.”

<sup>3</sup> For details, refer to the “Display Audio System Owner’s Manual.”

**NOTE:** For vehicles equipped with Entune™, please consult the “Navigation System With Entune Quick Reference Guide” or [www.toyota.com/entune](http://www.toyota.com/entune).

### Instrument cluster

Vehicles without a multi-information display

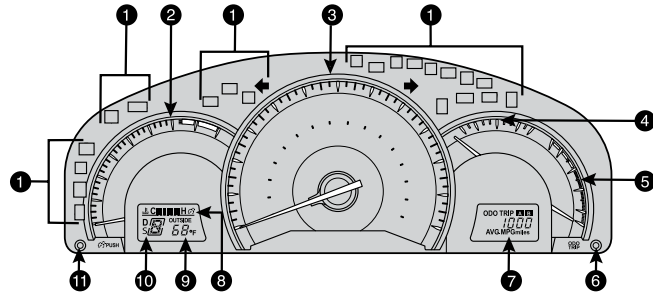

Vehicles with a multi-information display

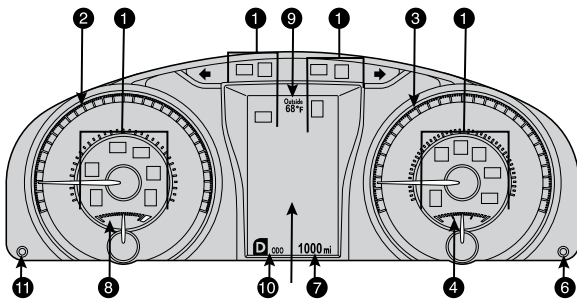

- 1 Service indicators and reminders
- 2 Tachometer
- 3 Speedometer
- 4 Fuel gauge
- 5 Average fuel consumption meter
- 6 Display change button
- 7 Odometer/Trip meter
- 8 Engine coolant temperature display
- 9 Outside temperature display
- 10 Shift position/Shift range display
- 11 Instrument panel light control button

### Indicator symbols

For details, refer to “Indicators and warning lights,” Section 2-2, 2014 Owner’s Manual.

**BRAKE** Brake system warning<sup>1</sup>

Driver/Front passenger seat belt reminder (alarm will sound if speed is over 12 mph)

Pre-collision system warning<sup>1</sup>

Electric power steering system warning<sup>1</sup>

Charging system warning<sup>1</sup>

Master system warning<sup>1</sup>

Low engine oil pressure warning<sup>1</sup>

Malfunction/Check Engine indicator<sup>1</sup>

Maintenance required reminder<sup>1</sup>

Low fuel level warning

Open door warning

SRS airbag warning<sup>1</sup>

Low Tire Pressure Warning<sup>1</sup>

Low windshield washer fluid warning<sup>1</sup>

Theft deterrent/Engine immobilizer system indicator

Headlight low/high beam indicator

Automatic high beam indicator

Turn signal indicator

Slip indicator<sup>1</sup>

Vehicle Stability Control OFF indicator<sup>1</sup>

Traction Control OFF indicator<sup>1</sup>

**SET** Cruise control indicator<sup>2</sup>/Cruise control SET indicator<sup>2</sup>

**ABS** Anti-lock Brake System warning<sup>1</sup>

Land Departure Alert (LDA) warning<sup>1</sup>

**PASS AIR BAG ON/OFF** Passenger Air Bag ON/OFF indicator<sup>1</sup>

**ECO** Eco Driving indicator<sup>1</sup>

<sup>1</sup> If indicator does not turn off within a few seconds of starting engine, there may be a malfunction. Have vehicle inspected by your Toyota dealer.

<sup>2</sup> If this light flashes, refer to “Cruise control,” Section 2-4, 2015 Owner’s Manual.

<sup>3</sup> Light flashes in yellow to indicate a malfunction. Light flashes quickly in green to indicate that the steering lock has not been released.

Keyless entry (if equipped)

Locking operation

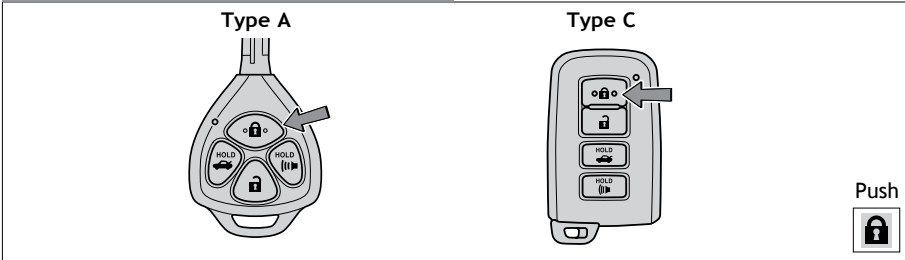

Unlocking operation

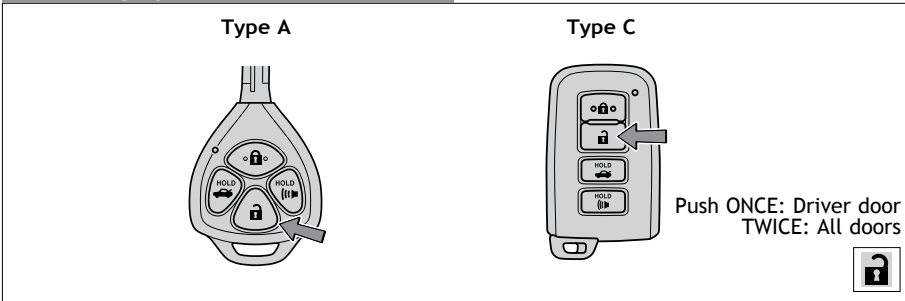

**NOTE:** If a door is not opened within 60 seconds of unlocking, all doors will relock for safety.

Trunk lid

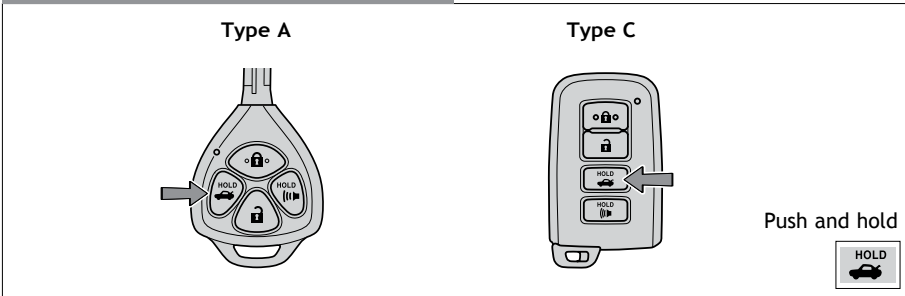

Panic button



Smart Key system (if equipped)

Start function

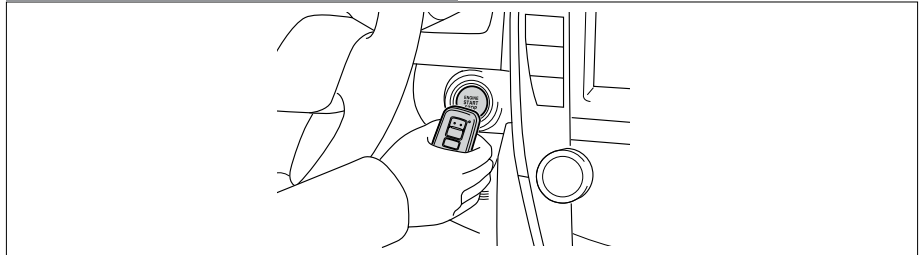

**NOTE:** Gear shift lever must be in Park and brake pedal depressed.

Power (without starting engine)

Without depressing the brake pedal, pressing the “ENGINE START STOP” switch will change the operation mode in succession from:

- ACC** Accessories such as the radio will operate.
- ON** Power ON; the engine not running.
- OFF** All systems OFF.

Locking operation

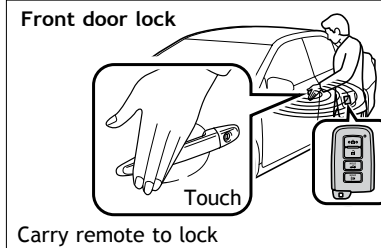

Unlocking operation

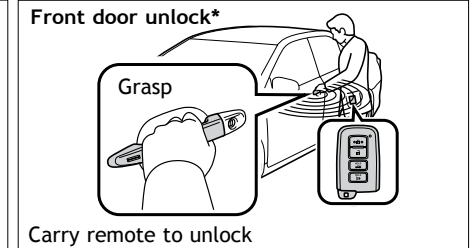

Trunk lock/unlock

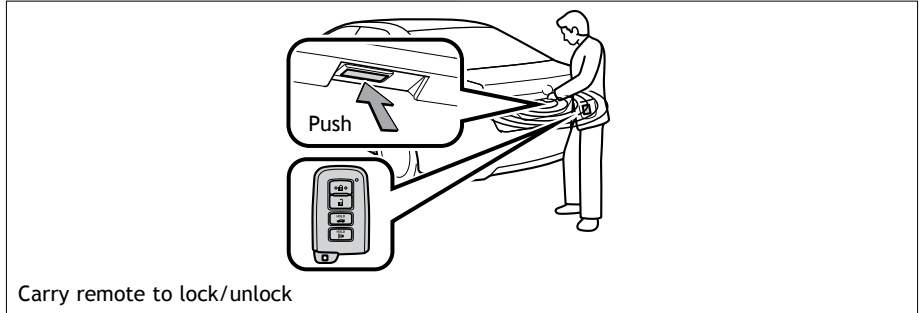

\* Driver door unlocking function can be programmed to unlock driver door only, or all doors. Grasping front passenger door handle will unlock all doors.

**NOTE:** Doors may also be locked/unlocked using remote.

### Fuel tank door release and cap

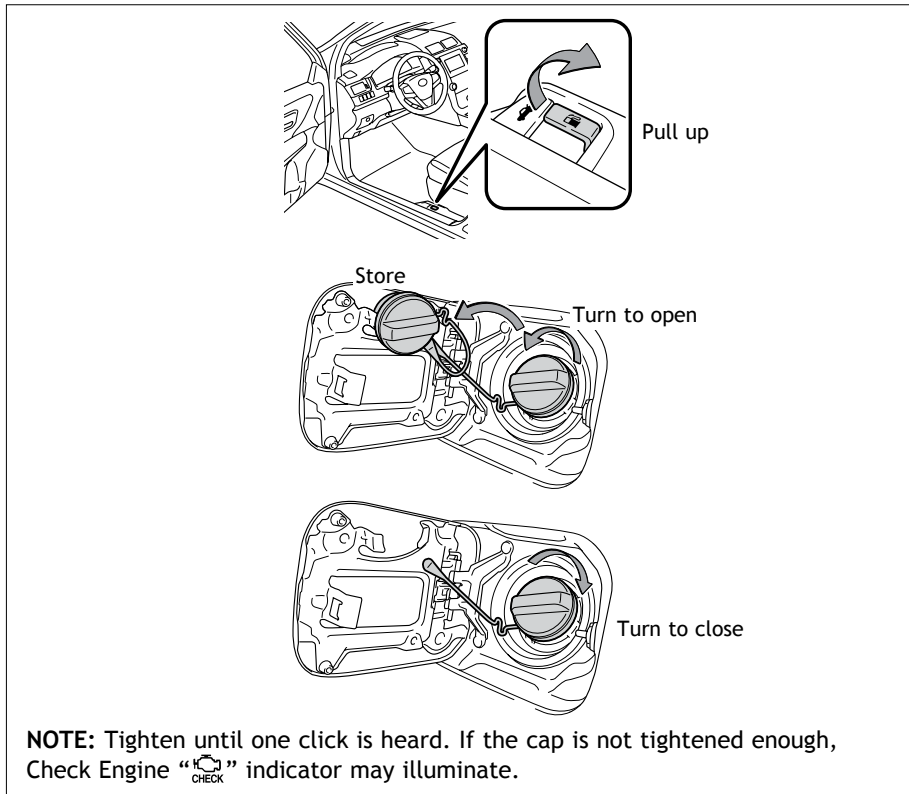

### Light control-Instrument panel

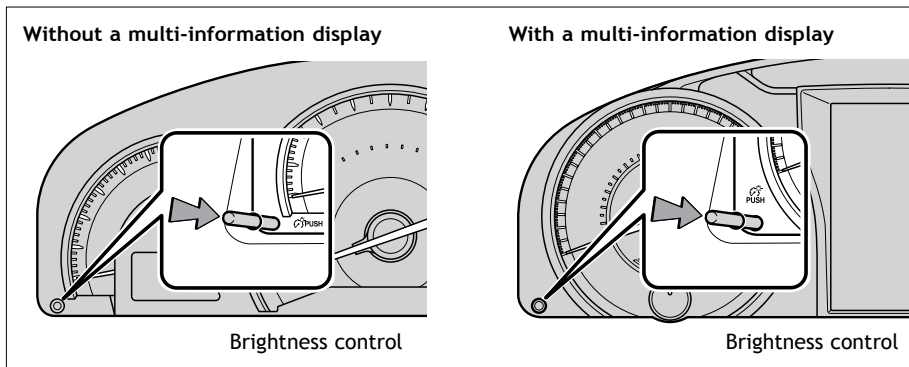

### Hood release

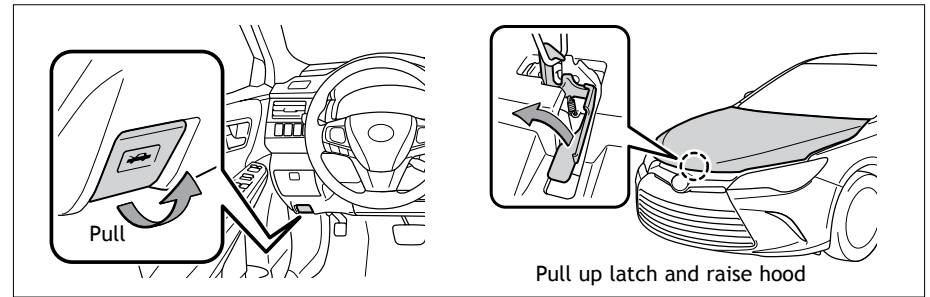

### Engine maintenance

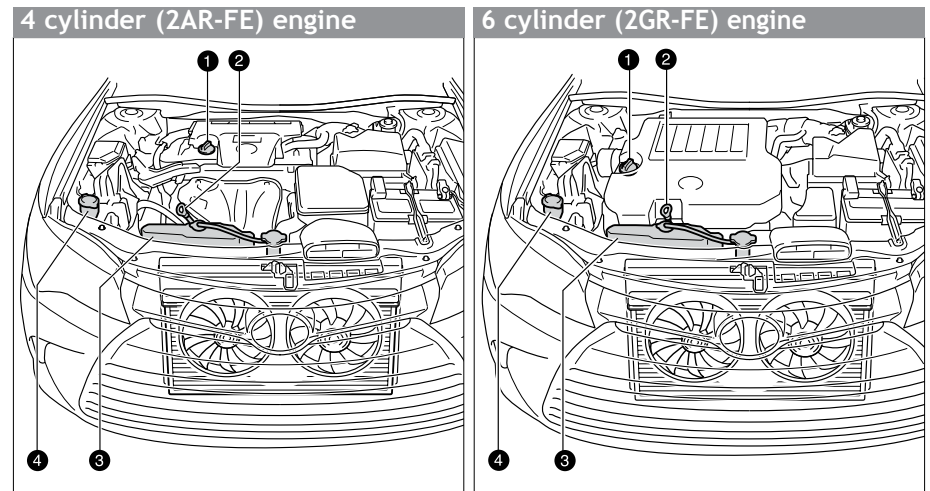

- ① Engine oil filler cap
- ② Engine oil level dipstick
- ③ Engine coolant reservoir
- ④ Windshield washer fluid tank

**NOTE:** Regularly scheduled maintenance, including oil changes, will help extend the life of your vehicle and maintain performance. Please refer to the “Warranty Maintenance Guide.”

# FEATURES/OPERATIONS

## Auto lock/unlock

Automatic door locks can be programmed to operate in four different modes, or turned OFF.

- Doors lock when shifting from Park.
- Doors lock when the vehicle speed goes above approximately 12 mph.
- Doors unlock when shifting into Park.

### Vehicles without Smart Key system

-Doors unlock when the ignition switch is set from "ON" to "ACC" or "LOCK" and driver's door is opened.

### Vehicles with Smart Key system

-Doors unlock when the "ENGINE START STOP" switch is set to OFF and driver's door is opened.

Refer to the *Owner's Manual* for more details.

## Automatic Transmission

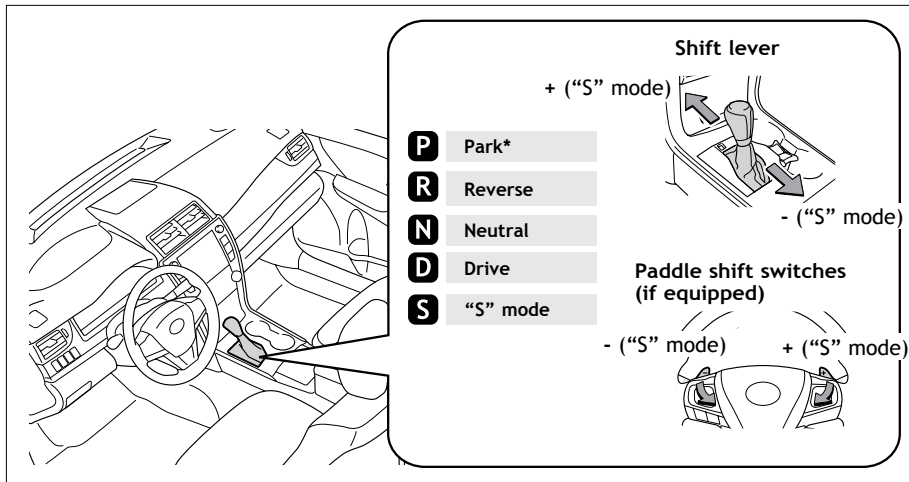

\* The "ENGINE START STOP"/ignition switch must be "ON" and the brake pedal depressed to shift from Park.

### "S" (Sequential) mode

Shift the shift lever to "S" position from "D" position.

- +: Upshifting
- : Downshifting

Downshifting increases power going uphill, or provides engine braking downhill. For best fuel economy during normal driving conditions, always drive with the shift lever in the "D" position.

## Steering lock release

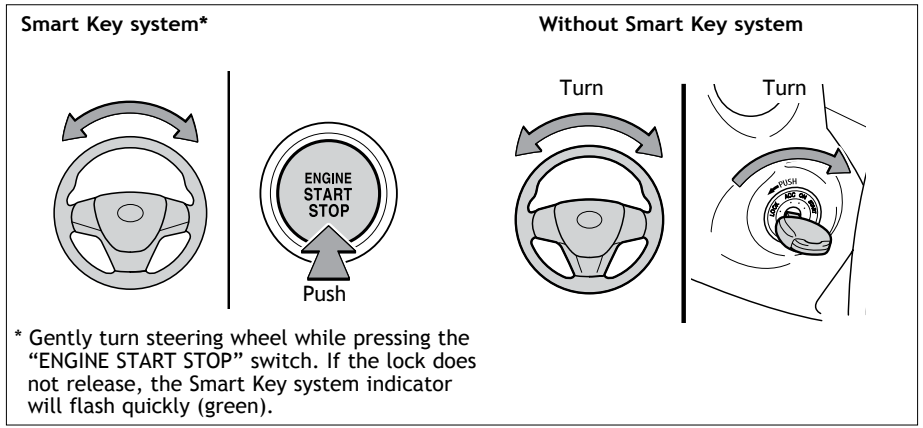

## Tilt and telescopic steering wheel

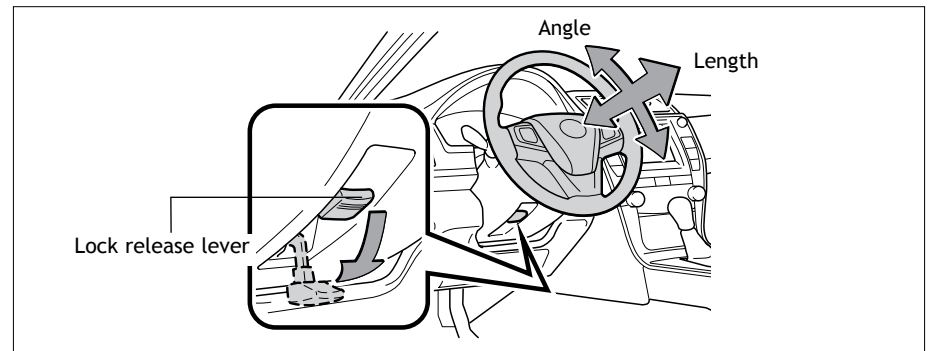

Hold wheel, push lever down, set angle and length, and return lever.

**NOTE: Do not attempt to adjust while the vehicle is in motion.**

## Parking brake

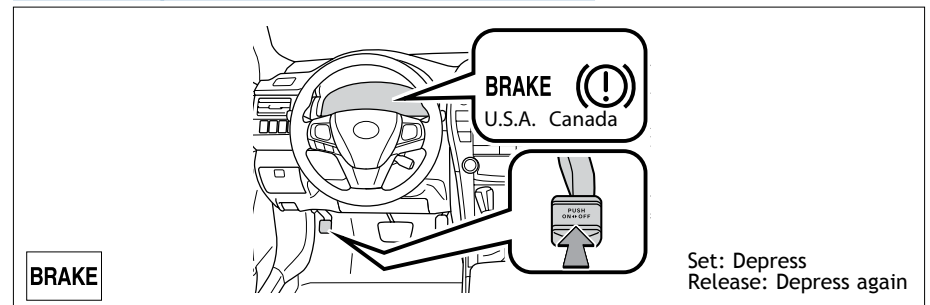

## Windows-Power

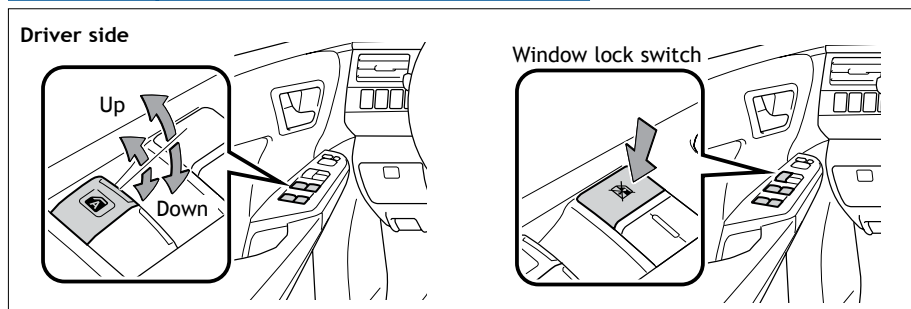

**Automatic operation (driver's and passenger's side)** Push the switch completely down or pull it completely up and release to fully open or close. To stop the window partway, operate the switch in the opposite direction.

**Window lock switch** Deactivates all passenger windows. Driver's window remains operable.

## Moonroof (if equipped)

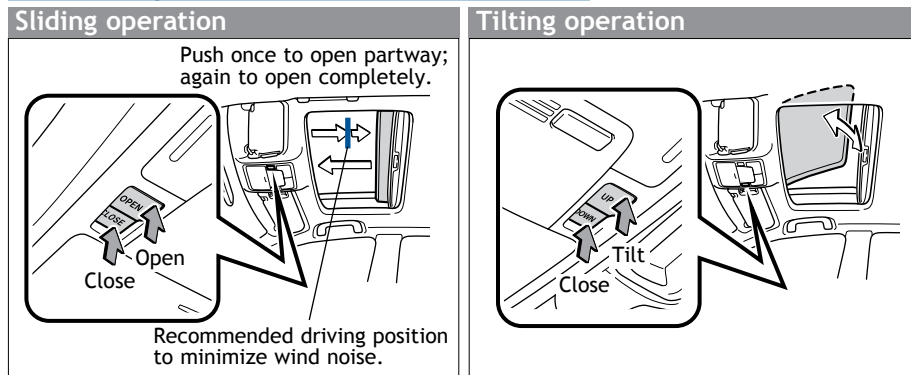

Push once to open; moonroof will automatically stop at the recommended position. Push again to open completely.

## Seats-Head restraints

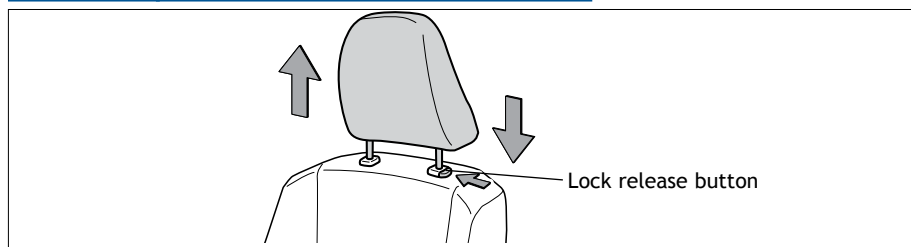

## Seat adjustments-Front

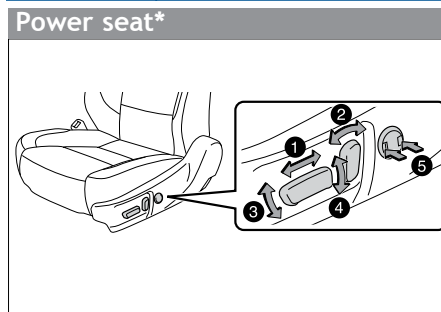

- 1 Seat position (forward/backward)
- 2 Height crank (driver side only)
- 3 Seatback angle
- 4 Seat position, cushion angle (driver side only) and height (driver side only)
- 5 Lumbar support (driver side only)

\*Power passenger seat equipped on some models, see *Owner's Manual* for more details.

## Seat adjustments-Rear

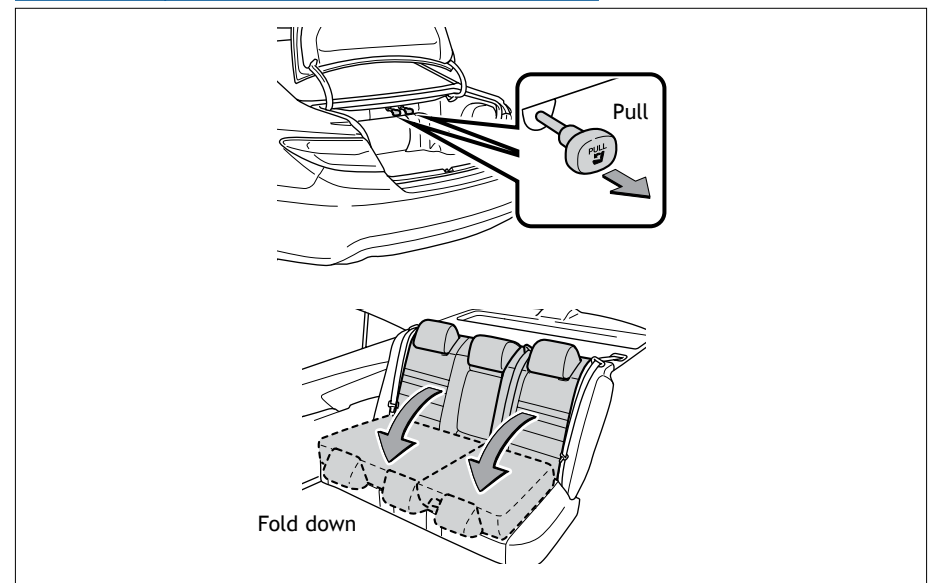

Refer to the *Owner's Manual* for more details.



### Windshield wipers & washers

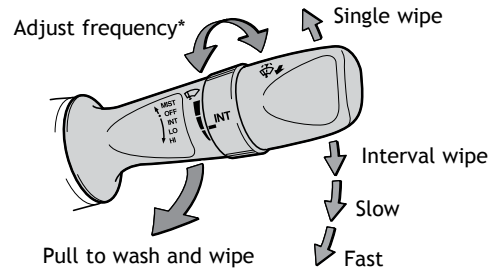

\* Intermittent windshield wiper frequency adjustment  
Rotate to increase/decrease wipe frequency.

### Power outlets-12V DC

Front console

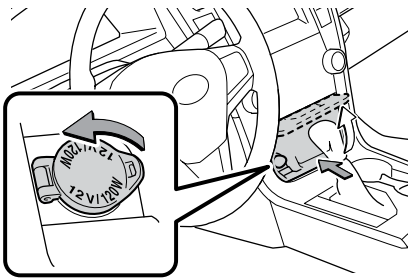

Center console (if equipped)

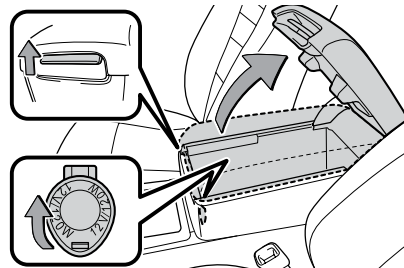

The “ENGINE START STOP” switch/ignition switch must be in the “ACC” or “ON” position for use.

### Lights & turn signals

#### Headlights

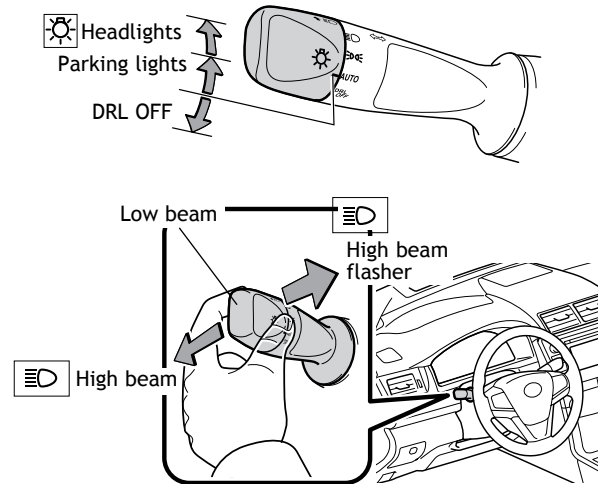

-**Daytime Running Light system (DRL)** Automatically turns on the headlights at a reduced intensity.  
-**Automatic light cut off system** Automatically turns lights off after 30-second delay, or lock switch on remote may be pushed after locking.

#### Turn signals

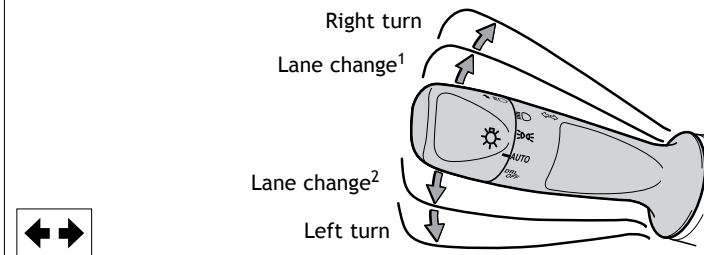

<sup>1</sup> The right hand signals will flash three times.  
<sup>2</sup> The left hand signals will flash three times.

### Garage door opener (HomeLink®)\* (if equipped)

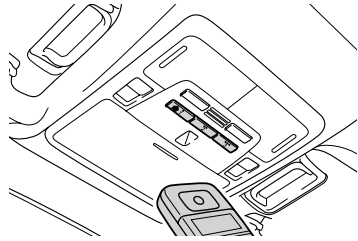

Garage door openers manufactured under license from HomeLink®\* can be programmed to operate garage doors, estate gates, security lighting, etc.

Refer to “Garage door opener,” Section 3-5 in the *Owner’s Manual* for more details.

For programming assistance, contact HomeLink® at 1-800-355-3515, or visit <http://www.homelink.com>.

\* HomeLink® is a registered trademark of Gentex Corporation.

### Cruise control

#### Turning system ON/OFF

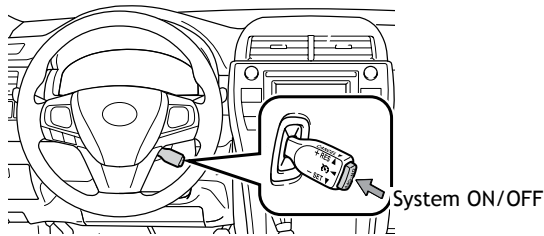

#### Functions

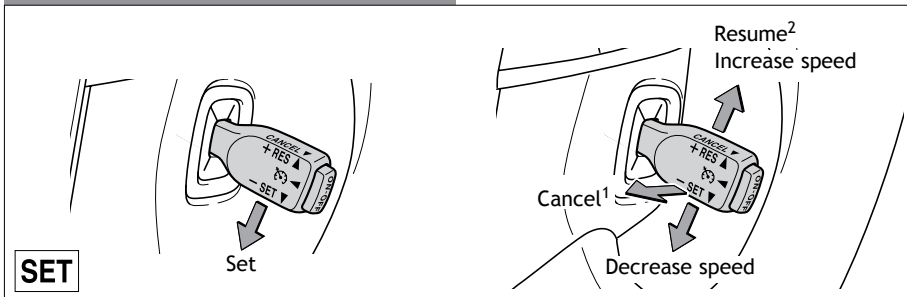

<sup>1</sup> The set speed may also be cancelled by depressing the brake pedal.  
<sup>2</sup> The set speed may be resumed once vehicle speed exceeds 25 mph.

### BSM (Blind Spot Monitor)(if equipped)

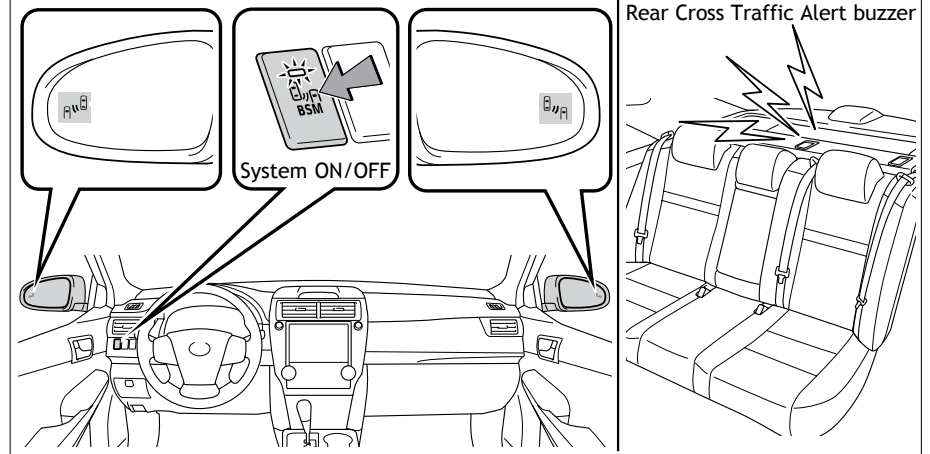

The Blind Spot Monitor is a system that has two functions:

- The Blind Spot Monitor function (assists the driver in decision-making when changing lanes)
- The Rear Cross Traffic Alert function (assists the driver when backing up)

The Blind Spot Monitor function uses radar sensors to detect vehicles that are traveling in an adjacent lane in the area that is not reflected in the outside rear view mirror (the blind spot), and advises the driver of the vehicles existence via the outside rear view mirror indicator.

Refer to the *Owner’s Manual* for more details on this system before attempting to use it.

### Rear view monitor system

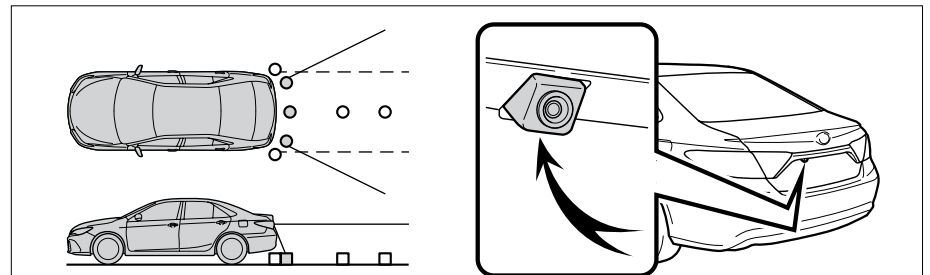

The rear view monitor system displays an image of the view from the bumper of the rear area of the vehicle. The camera for the rear view monitor system is located above the license plate.

To adjust the image on the rear view monitor screen, press the “SETUP” button and select “Display” on the “Setup” screen. Select “Camera” to adjust the screen contrast and brightness.

Refer to the *Owner’s Manual* for more details on this system.

### Clock

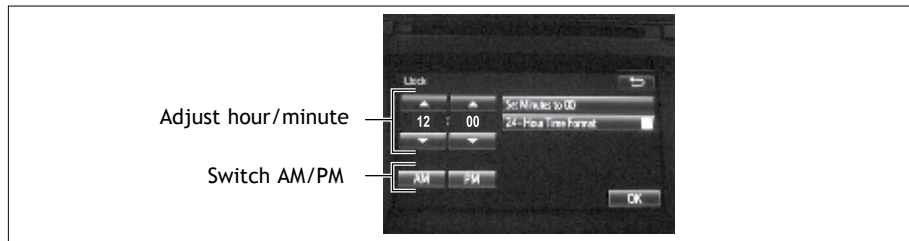

Press the “SETUP” button and select “General” and then select “Clock”. Refer to the *Owner’s Manual* for more details on setting the clock. For vehicles with a navigation system or Entune Audio Plus, refer to the *Navigation and Multimedia System Owner’s Manual*.

### Air Conditioning/Heating

#### Automatic Air Conditioning

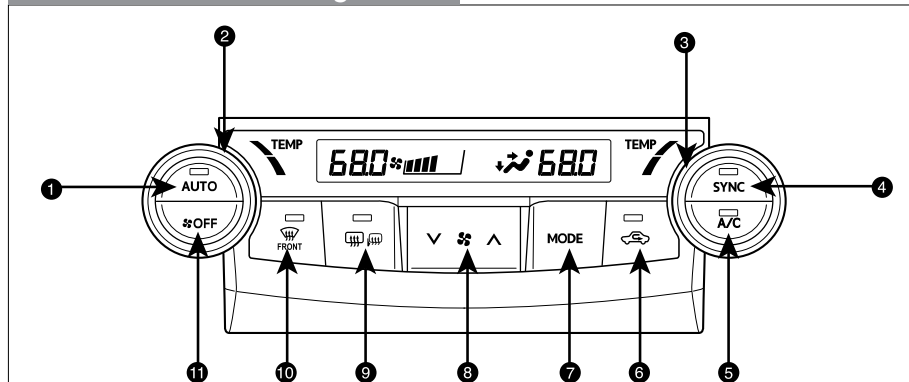

- 1 Automatic climate control ON  
Adjusting the temperature setting will cause the airflow vents, air intake and fan to adjust automatically.
- 2 Temperature selector (driver side)
- 3 Temperature selector (passenger side)
- 4 “SYNC” button  
Indicator ON: Synchronized temperature settings for driver and passengers.  
Indicator OFF: Separate temperature settings for driver and passengers.
- 5 Air Conditioning ON/OFF
- 6 Recirculate cabin air (outside air when OFF)
- 7 Airflow vent  
In “” or “” mode, use outside air (“” indicator OFF) to reduce window fogging.
- 8 Fan speed
- 9 Outside rearview mirror/Rear defogger
- 10 Windshield airflow/defogger
- 11 Climate control OFF

#### Manual Air Conditioning

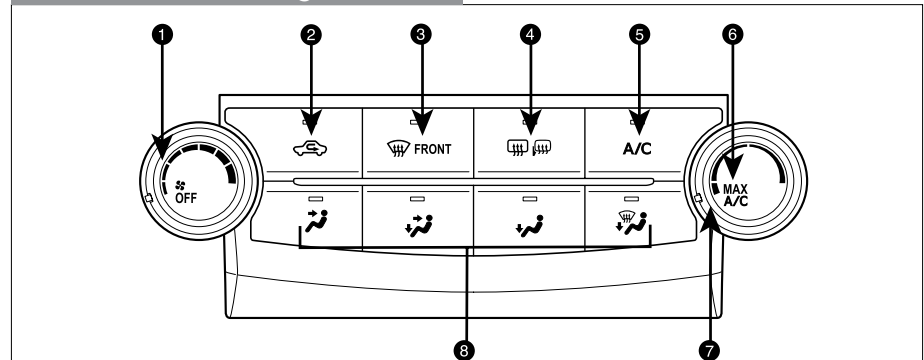

- 1 Fan speed
- 2 Recirculate cabin air (outside air when OFF)
- 3 Windshield airflow/defogger
- 4 Outside rearview mirror defoggers\*/Rear defogger
- 5 Air Conditioning ON/OFF  
Use outside air to quickly cool interior, then change to recirculate for cooler air.
- 6 Select for maximum cooling. Air intake will automatically be set to recirculate. It is not possible to change intake to outside, or to turn A/C OFF in this mode.
- 7 Temperature selector
- 8 Airflow vent  
In “” mode, use outside air (“” indicator OFF) to reduce window fogging. “” mode uses outside air only.

\* If equipped

#### Seat heaters (if equipped)

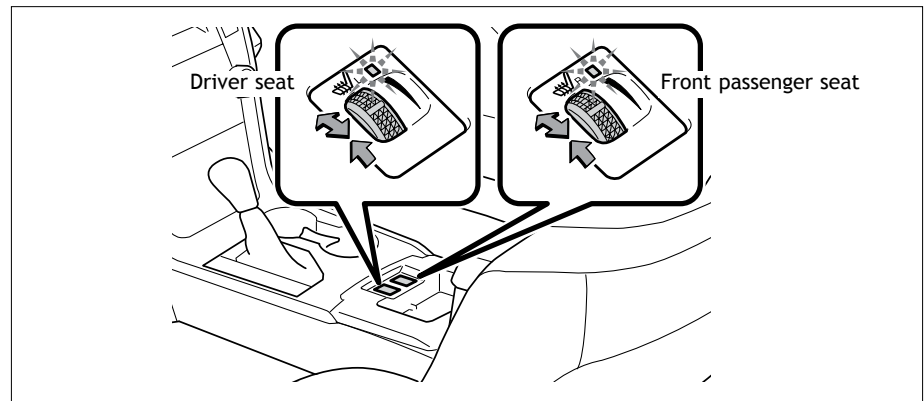

## Steering wheel switches and Telephone controls (Bluetooth®)

Steering Wheel Right Side switches Type A

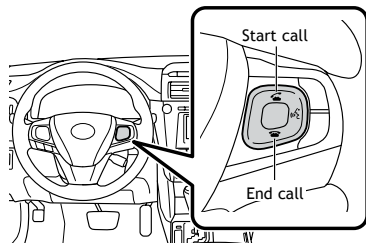

Steering Wheel Right Side switches Type B

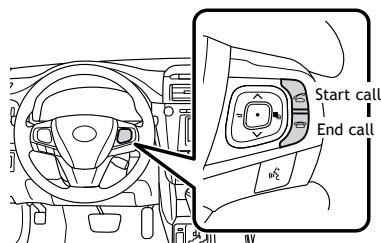

Steering Wheel Left Side switches

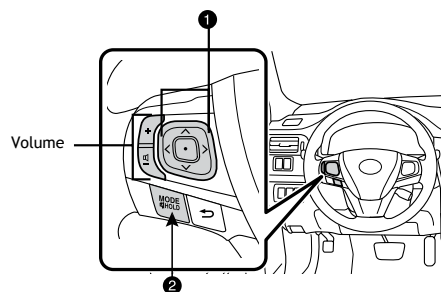

- 1 “▲ ▼” Use to search within the selected audio medium (radio, CD, iPod®, etc.).
- 2 “MODE” Push to turn audio ON and select an audio mode. Push and hold to turn the audio OFF.

Microphone

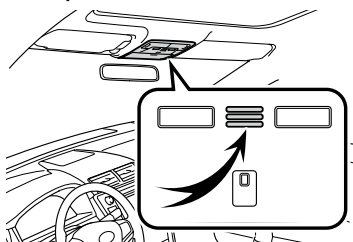

Bluetooth® technology allows dialing or receipt of calls without taking hands from the steering wheel or using a cable to connect the compatible telephone and the system.

Refer to “Bluetooth® audio/phone,” Section 5-2 in the *Owner’s Manual*, for more information about phone connections and compatibility.

## Audio

Type 1

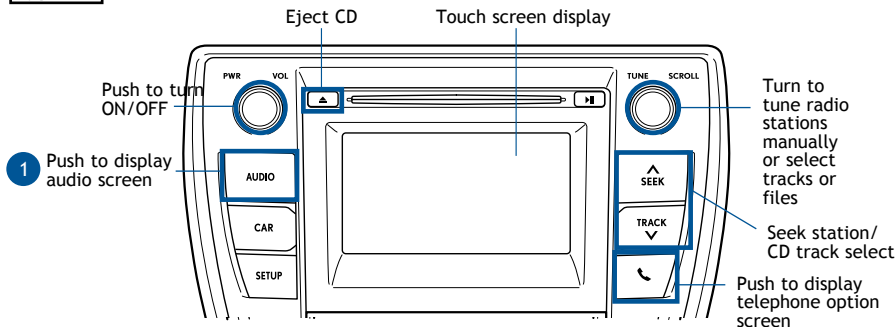

Type 2 - Entune Audio Plus (additional functions)

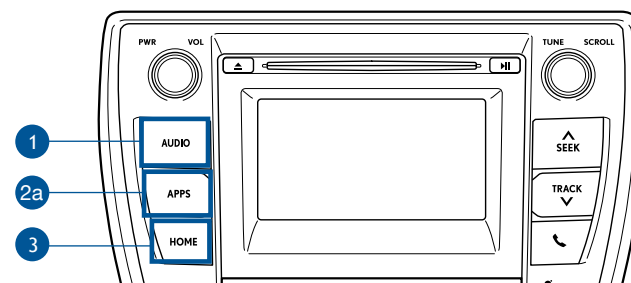

Type 3 - Entune Premium Audio with Navigation and App Suite (additional functions)

*Some XLE and XSE models may be equipped with the JBL upgrade in this unit.*

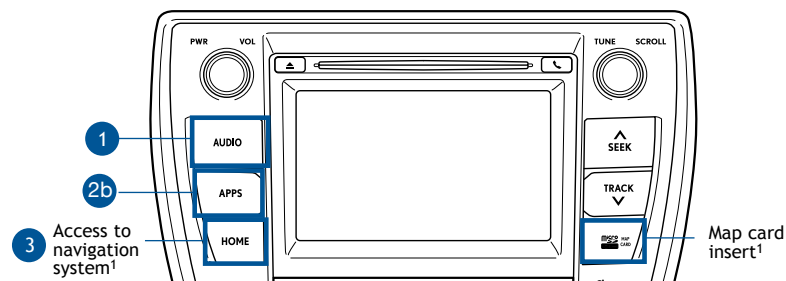

¹ Refer to the “NAVIGATION AND MULTIMEDIA SYSTEM OWNER’S MANUAL”.

- |  |   |
|--|---|
| <ol style="list-style-type: none"> <li>1 AUDIO Button<br/>Access to audio functions.</li> <li>2a APPS Button<br/>Access to traffic and weather</li> <li>2b APPS Button<br/>Access to Entune® App Suite, sports, stocks, news, traffic and weather</li> </ol> | <ol style="list-style-type: none"> <li>3 HOME Button<br/>Access to Home screen.<br/><br/>HOME SCREEN - the home screen offers a two panel and a three panel layout. Information and layout will vary depending on selected set up.</li> </ol> |
|--|---|

### iPod®/USB/AUX port

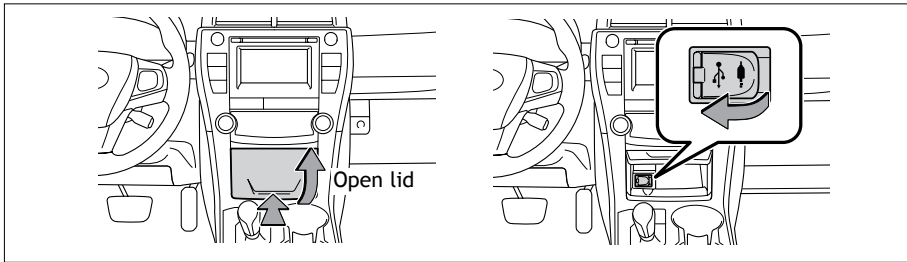

By connecting a USB-compatible portable audio device or USB memory to the USB port, you can listen to music from the portable audio device or USB memory through the vehicle's speaker system. By inserting a mini plug into the AUX port, you can listen to music from a portable audio device through the vehicle's speaker system while in AUX mode.

### Traffic (Entune Audio Plus only)



The Traffic App displays a scrollable map showing local traffic in 3 colors. Traffic conditions are displayed in red, yellow and green for heavy, moderate or light traffic conditions. Use or arrows to scroll the map up or down.

### Weather (Entune Audio Plus only)

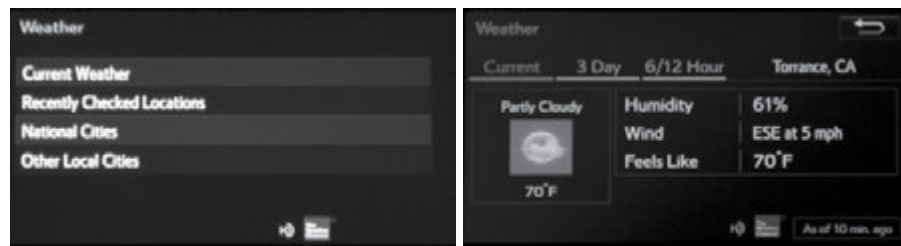

The Weather App options show current weather and recently checked locations weather. You can also search for a weather forecast by national or local cities.

Always drive safely, obey traffic laws & focus on the road while driving. Availability and accuracy of the information provided by HD services is dependent upon many factors. Services not available in every city or roadway. Use common sense when relying on information provided. HD Radio(tm) Technology manufactured under license from iBiquity Digital Corporation U.S. and Foreign Patents. HD Radio(tm) and the HD, HD Radio, and "Arc" logos are proprietary trademarks of iBiquity Digital Corp.

### Cup holders

#### Front

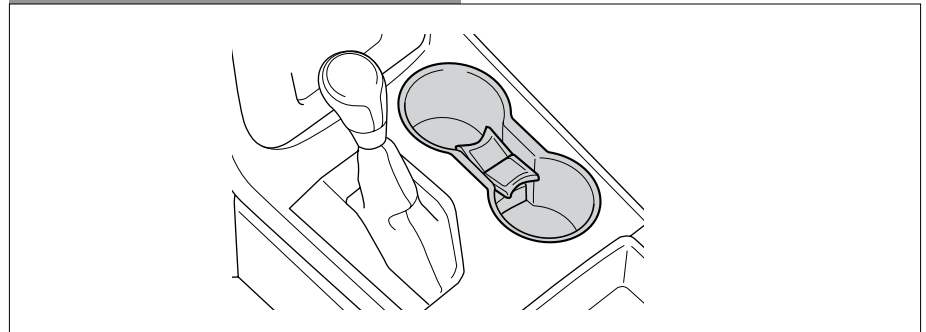

#### Rear

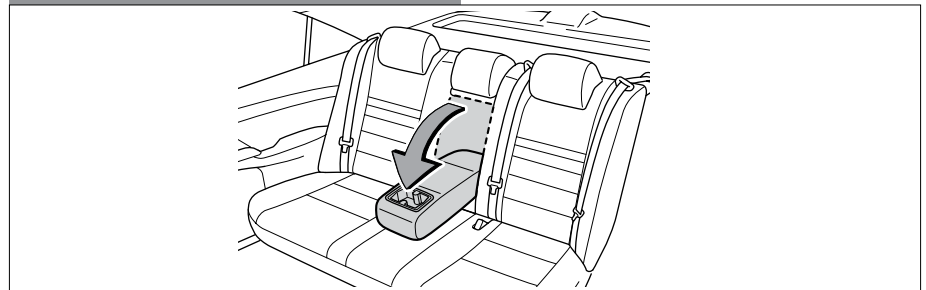

### Bottle holders

#### Front door

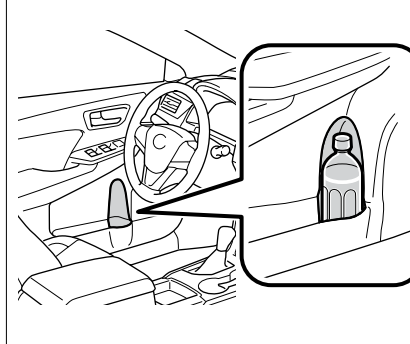

#### Rear door

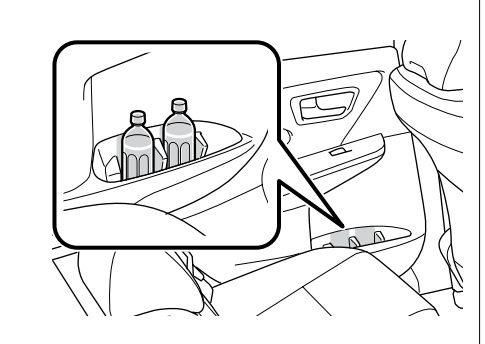

### Wireless Charging (if equipped)

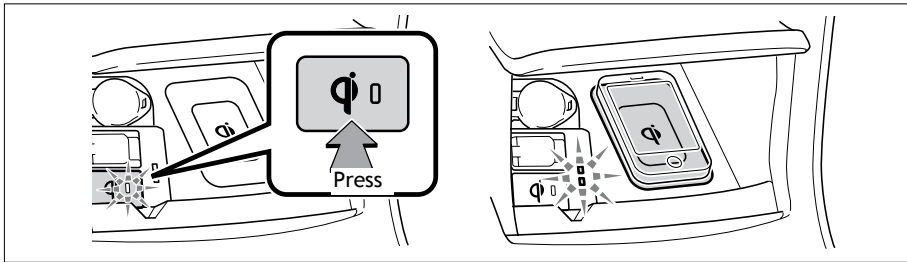

A mobile device can be charged wirelessly on the tray. Open the lid and press the wireless charger switch. Place a mobile device on the tray as shown in the illustration. An amber indicator is illuminated while charging is in progress. When charging is complete, a green indicator will also be illuminated. Some phones, cases or cover type wireless chargers may not cause the green indicator to illuminate even though it is fully charged.

Refer to the *Owner's Manual* for more details on this system before attempting to use it.

### Multi-information display (if equipped)

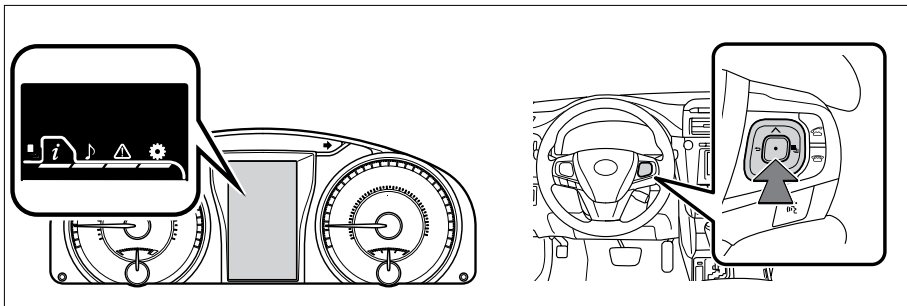

Push “meter control switches” to change information in the following:

- (1) Drive information
- (2) Navigation system linked display
- (3) Audio system linked display
- (4) Dynamic radar cruise control
- (5) LDA (Lane Departure Alert) status
- (6) Warning messages
- (7) Settings display

### Pre-collision system (PCS) (if equipped)

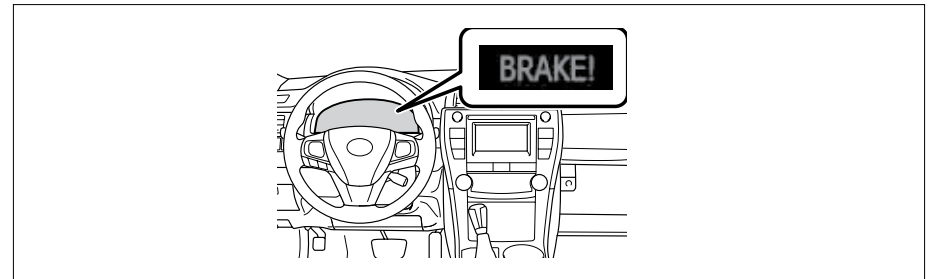

When the radar sensor detects possibility of a frontal collision, brakes are automatically engaged to lessen impact as well as vehicle damage. The alert timing for the pre-collision system can be changed or turned on/off, as necessary, by operating the switch.

Refer to the *Owner's Manual* for more details on this system before attempting to use it.

### Lane Departure Alert (LDA) (if equipped)

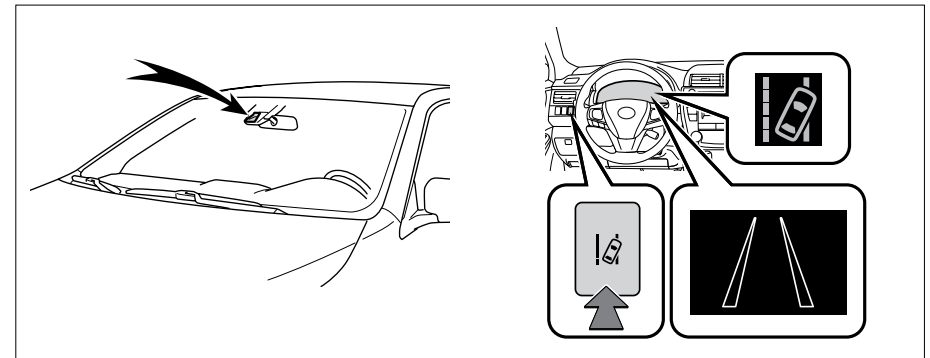

The Lane Departure Alert recognizes the visible lane markers using a camera as a sensor and alerts the driver with beeping and flashing indicators when the vehicle deviates from its lane. Press the LDA switch to activate the system.

Refer to the *Owner's Manual* for more details on this system before attempting to use it.

# SAFETY AND EMERGENCY FEATURES

## Door locks

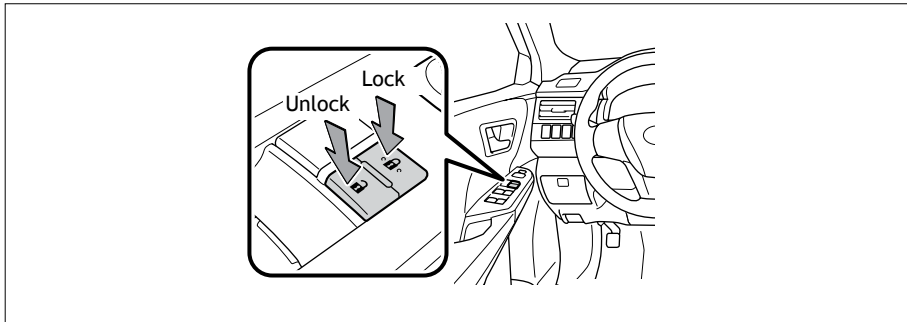

## Doors-Child safety locks



Moving the lever to downward will allow the door to be opened only from the outside.

## Seat belts

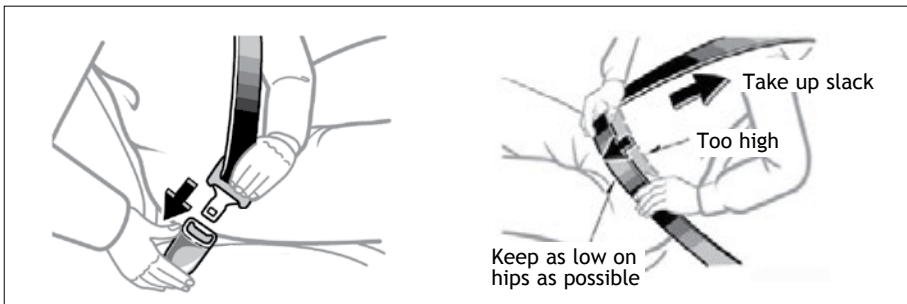

If belt is fully extended, then retracted even slightly, it cannot be re-extended beyond that point, unless fully retracted again. This feature is used to help hold child restraint systems securely.

To find more information about seat belts, and how to install a child restraint system, refer to the *Owner's Manual*.

## Seat belts-Shoulder belt anchor

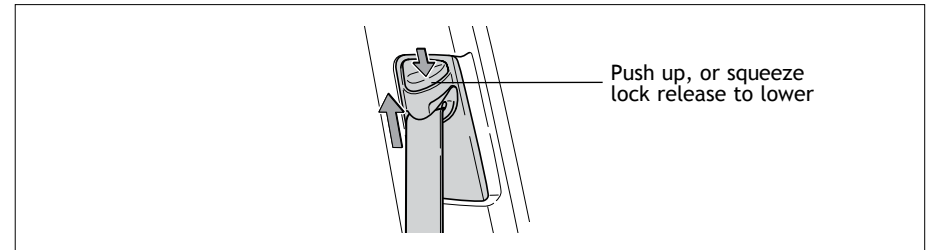

## Safety Connect (if equipped)

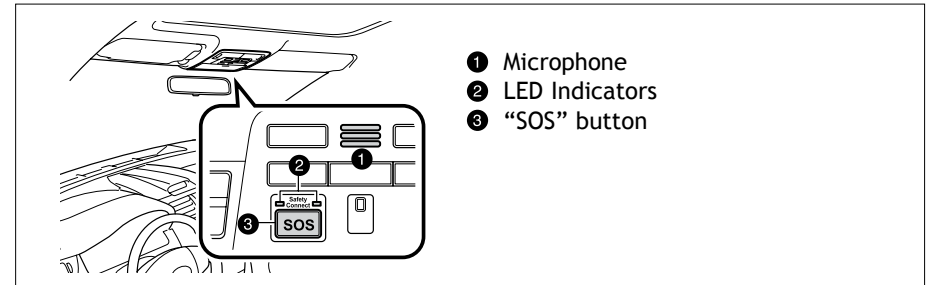

Safety Connect is a subscription-based telematics service that uses Global Positioning System (GPS) data and embedded cellular technology to provide safety and security features to subscribers. Safety Connect is supported by Toyota's designated response center, which operates 24 hours per day, 7 days per week. Services for subscribers include: Automatic collision notification, Stolen vehicle location, Emergency assistance button and Enhanced roadside assistance

Contact your dealer for more information about Safety Connect.

## Spare tire & tools

### Tool location

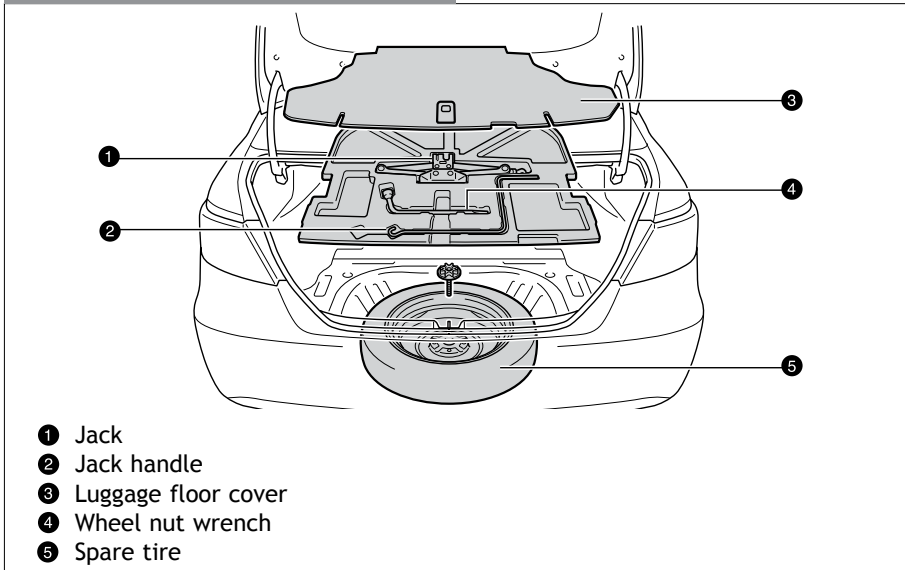

### Removing the spare tire

(1) Remove the tool tray.

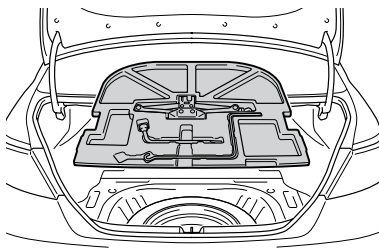

(2) Loosen the center fastener that secures the spare tire.

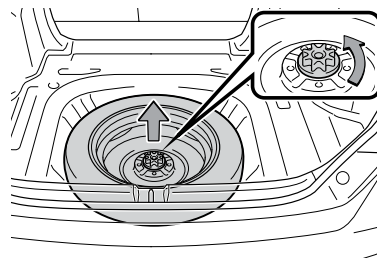

Refer to the *Owner's Manual* for tire changing and jack positioning procedures.

### Trunk-Internal release

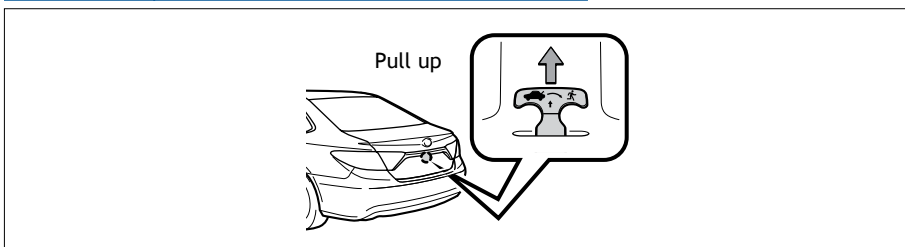

## Star Safety System™

All new Toyota vehicles come standard with the Star Safety System™, which combines Vehicle Stability Control (VSC), Traction Control (TRAC), Anti-lock Braking System (ABS), Electronic Brake-force Distribution (EBD), Brake Assist (BA) and Smart Stop Technology (SST).

### Vehicle Stability Control (VSC)

VSC helps prevent loss of traction during cornering by reducing engine power and applying brake force to selected wheels.

Toyota's VSC monitors steering angle and the direction your vehicle is traveling. When it senses that the front or rear wheels begin to lose traction, VSC reduces engine power and applies braking to selected wheels. This helps restore traction and vehicle control.

### Traction Control (TRAC)

VSC helps prevent loss of traction during cornering by reducing engine power, and Traction Control helps maintain traction on loose gravel and wet, icy, or uneven surfaces by applying brake force to the spinning wheel(s).

Toyota's TRAC sensors are activated when one of the drive wheels starts to slip. TRAC limits engine output and applies the brakes to the spinning wheel. This transfers power to the wheels that still have traction to help keep you on track.

### Anti-Lock Brake System (ABS)

ABS helps prevent brakes from locking up by "pulsing" brake pressure to each wheel. This limits brake lockup and helps provide directional control for the current road conditions.

Toyota's ABS sensors detect which wheels are locking up and limits wheel lockup by "pulsing" each wheel's brakes independently. Pulsing releases brake pressure repeatedly for fractions of a second. This helps the tires attain the traction that current road conditions will allow, helping you to stay in directional control.

### Electronic Brake Force Distribution (EBD)

Toyota's ABS technology has Electronic Brake-force Distribution (EBD) to help maintain control and balance when braking. Abrupt stops can cause a vehicle to tilt forward, reducing the braking power of the rear wheels. EBD responds to sudden stops by redistributing brake force to enhance the braking effectiveness of all four wheels.

### Brake Assist (BA)

Brake Assist is designed to detect sudden or "panic" braking, and then add braking pressure to help decrease the vehicle's stopping distance. When there's only a split second to react, Brake Assist can add additional brake pressure more quickly than just the driver alone can.



### Smart Stop Technology (SST)

Smart Stop Technology automatically reduces driving torque when the accelerator and brake pedals are pressed simultaneously under certain conditions.

SST engages when the accelerator is depressed first and the brakes are applied firmly for longer than one-half second at speeds greater than five miles per hour.

SST doesn't engage if the brake pedal is depressed before the accelerator pedal, allowing vehicles to start on a steep hill and safely accelerate without rolling backward.

### Floor mat installation

There are two types of Toyota floor mats: carpeted and all-weather. Each vehicle has model-specific floor mats. Installation is easy.

To keep your floor mat properly positioned, follow these steps:

- Only use floor mats designed for your specific model.
- Use only one floor mat at a time, using the retaining hooks to keep the mat in place.
- Install floor mats right side up.

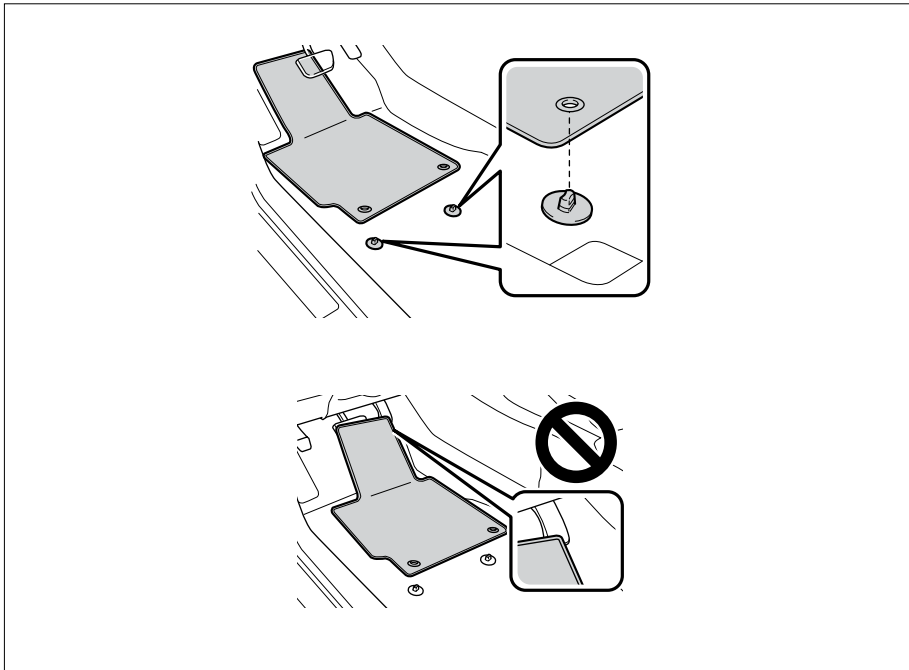

## BLUETOOTH® DEVICE PAIRING SECTION

To begin the Bluetooth® Pairing process, press the HOME button on the faceplate of your Toyota Vehicle Entune™ Multimedia Head Unit.<sup>1</sup>

### Bluetooth® Pairing for Android® phone and Entune™ touch screen system

Pairing your phone is the first step in connecting with your Toyota for hands-free calling and for audio streaming via Bluetooth. This pairing process is quick and easy: all Android mobile digital devices have Bluetooth integrated; all you have to do is setup the phone and multimedia system to “talk” to each other and form a connection.<sup>2</sup>

#### Initiate Bluetooth® on your Android®

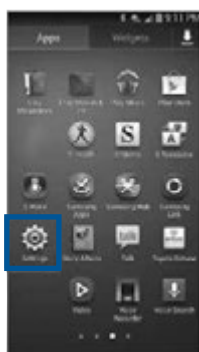

**STEP 1**  
From your APPS SCREEN, select SETTINGS

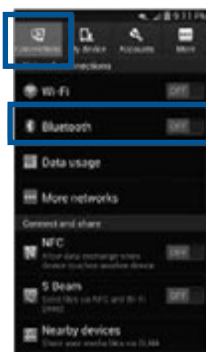

**STEP 2**  
Select CONNECTIONS and select BLUETOOTH



**STEP 3**  
Ensure BLUETOOTH is ON

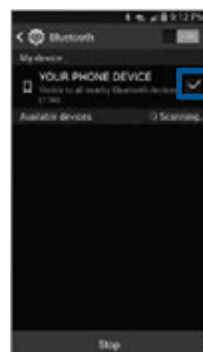

**STEP 4**  
Select YOUR PHONE DEVICE to make it discoverable.

*Phone will seek out Bluetooth devices while remaining discoverable.*



**STEP 5**  
While your Android device is seeking out Bluetooth devices, proceed to your Entune Multimedia Head Unit on your Toyota vehicle.

#### Initiate Bluetooth® on your Entune™ Multimedia Head Unit

Once you have Bluetooth enabled on your phone and ready to pair, you will need to initiate Bluetooth on your Entune head unit. Please follow the instructions below to pair your Bluetooth enabled phone to your Entune system.



**STEP 6**  
On your Toyota Vehicle Entune Multimedia Head Unit, Select SETUP BUTTON on the Home Screen.



**STEP 7**  
Select BLUETOOTH

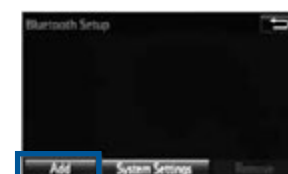

**STEP 8**  
Select ADD, to add your phone device

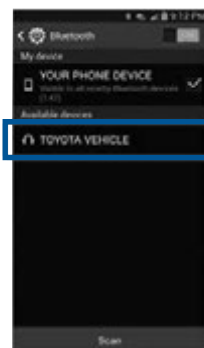

**STEP 9**  
Back on your smartphone, you can now select your TOYOTA VEHICLE in Bluetooth Settings.

*You may need to enter the provided Bluetooth PIN on your phone.*



**STEP 10**  
Your smartphone is now paired with Entune.

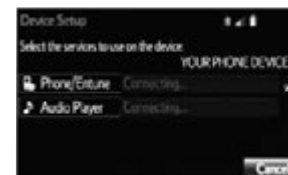

**STEP 11**  
Once paired, Entune will attempt to connect audio and contacts on your phone.

<sup>1</sup> To determine which head unit is installed in your vehicle, refer to page 21.

<sup>2</sup> Some Android devices may have slightly different SETTINGS screen layout depending on manufacturer of device and Android OS version.

Initiate Bluetooth® on your Entune™ Multimedia Head Unit (continued)

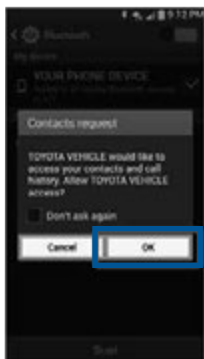

**STEP 12**

Using your smartphone, you will need to allow Entune access to your messaging and contacts

*It is recommended to check the "Don't ask again" box, so as not to have to press OK every time the phone makes a Bluetooth connection with your Toyota*

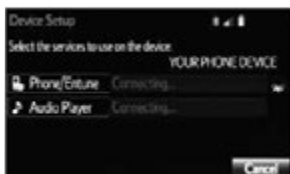

**STEP 13**

A confirmation will appear once your phone has been paired and connected.

**Additional Resources**

If you're having trouble pairing your phone, Toyota has you covered. You can get more information from the following sources:

Online Pairing Guide:  
[www.toyota.com/connect](http://www.toyota.com/connect)

Your Toyota Owner's Manual  
*Located in the vehicle glovebox*

Toyota Customer Experience Center  
(800) 331-4331

**Disclosures**

- This brochure is accurate at the time of print; content subject to change based on periodic multimedia software updates.
1. Concentrating on the road should always be your first priority while driving. Do not use the hands-free phone system if it will distract you.
  2. The Bluetooth word mark and logos are registered trademarks owned by Bluetooth SIG, Inc. and any use of such marks by Toyota is under license. A compatible Bluetooth enabled phone must first be paired. Phone performance depends on software, coverage & carrier.
  3. Android is a trademark of Google, Inc. All rights reserved. Google is not a participant in or sponsor of this promotion.
  4. Apps/services vary by phone/carrier; functionality depends on many factors. Select apps use large amounts of data; you are responsible for charges. Apps & services subject to change. See Toyota.com/entune for details.
  5. Bluetooth Pairing Guide for select 2015 models.

**Bluetooth® Pairing for iPhone® and Entune™ touch screen system**

Pairing your phone is the first step in connecting with your Toyota for hands-free calling and for audio streaming via Bluetooth. This pairing process is quick and easy: all iPhone mobile digital devices have Bluetooth integrated; all you have to do is setup the phone and multimedia system to "talk" to each other and form a connection. Bluetooth Pairing Guide for select 2015 models.

Initiate Bluetooth® on your iPhone®

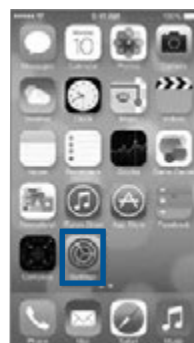

**STEP 1**

From the HOME SCREEN, select SETTINGS

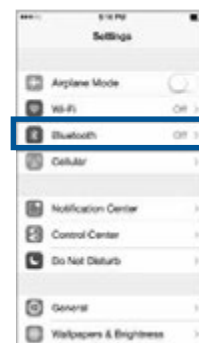

**STEP 2**

Select BLUETOOTH



**STEP 3**

Ensure BLUETOOTH is ON



**STEP 4**

Your iPhone will seek out Bluetooth devices while remaining discoverable



**STEP 5**

While your iPhone device is seeking out Bluetooth devices, proceed to your Entune Multimedia Head Unit on your Toyota vehicle.

*CONTINUE ON THE NEXT PAGE...*

## Initiate Bluetooth® on your Entune™ Multimedia Head Unit

Once you have Bluetooth enabled on your phone and ready to pair, you will need to initiate Bluetooth on your Entune head unit. Please follow the instructions below to pair your Bluetooth enabled phone to your Entune system.



**STEP 6**  
Select **SETUP** BUTTON on the Home Screen.



**STEP 7**  
Select **BLUETOOTH**

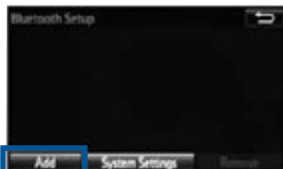

**STEP 8**  
Select **ADD**, to add your phone device



**STEP 9**  
Back on your smartphone, you can now select your **TOYOTA VEHICLE** in Bluetooth Settings.

*You may need to enter the provided Bluetooth PIN on your phone.*



**STEP 10**  
Your smartphone is now paired with Entune.

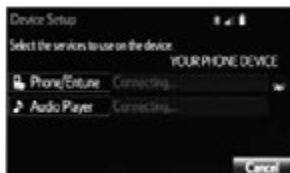

**STEP 11**  
Once paired, Entune will attempt to connect audio and contacts on your phone.

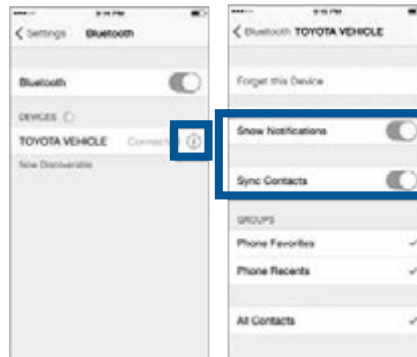

**STEP 12**  
Using your smartphone, you may need to allow Entune access to your messaging and contacts  
*Only current iPhone text messages can be viewed on the head unit. iPhone does not allow text message reply.*

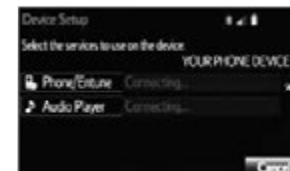

**STEP 13**  
A confirmation will appear once your phone has been paired and connected.

### Additional Resources

If you're having trouble pairing your phone, Toyota has you covered. You can get more information from the following sources:

Online Pairing Guide:  
[www.toyota.com/connect](http://www.toyota.com/connect)

Your Toyota Owner's Manual  
*Located in the vehicle glovebox*

Toyota Customer Experience Center  
(800) 331-4331

### Disclosures

This brochure is accurate at the time of print; content subject to change based on periodic multimedia software updates.

1. Concentrating on the road should always be your first priority while driving. Do not use the hands-free phone system if it will distract you.
2. The Bluetooth word mark and logos are registered trademarks owned by Bluetooth SIG, Inc. and any use of such marks by Toyota is under license. A compatible Bluetooth enabled phone must first be paired. Phone performance depends on software, coverage & carrier.
3. Android is a trademark of Google, Inc. All rights reserved. Google is not a participant in or sponsor of this promotion.
4. Apps/services vary by phone/carrier; functionality depends on many factors. Select apps use large amounts of data; you are responsible for charges. Apps & services subject to change. See Toyota.com/entune for details.
5. Bluetooth Pairing Guide for select 2015 models.

## Bluetooth® Pairing for Windows Phone® and Entune™ touch screen system

Pairing your phone is the first step in connecting with your Toyota for hands-free calling and for audio streaming via Bluetooth. This pairing process is quick and easy: all Windows Phone mobile digital devices have Bluetooth integrated; all you have to do is setup the phone and multimedia system to “talk” to each other and form a connection. Bluetooth Pairing Guide for select 2015 models.

### Initiate Bluetooth® on your Windows Phone®

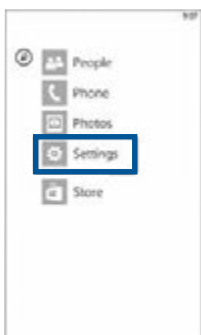

**STEP 1**  
From your APP LIST, select **SETTINGS**

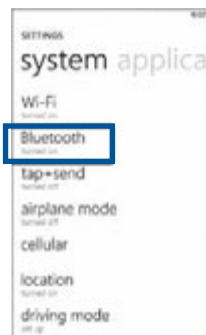

**STEP 2**  
Select **BLUETOOTH**



**STEP 3**  
Ensure **BLUETOOTH** is ON



**STEP 4**  
Phone will seek out Bluetooth devices while remaining discoverable



**STEP 5**  
While your iPhone device is seeking out Bluetooth devices, proceed to your Entune Multimedia Head Unit on your Toyota vehicle.

*CONTINUE ON THE NEXT PAGE...*

### Initiate Bluetooth® on your Entune™ Multimedia Head Unit

Once you have Bluetooth® enabled on your phone and ready to pair, you will need to initiate Bluetooth® on your Entune head unit. Please follow the instructions below to pair your Bluetooth enabled phone to your Entune system.



**STEP 6**  
On your Toyota Vehicle Entune Multimedia Head Unit, Select **SETUP BUTTON** on the Home Screen.



**STEP 7**  
Select **BLUETOOTH**

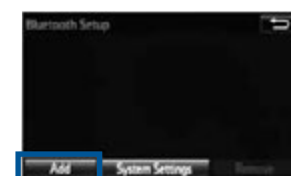

**STEP 8**  
Select **ADD**, to add your phone device



**STEP 9**  
Back on your smartphone, you can now select your **TOYOTA VEHICLE** in Bluetooth Settings.

*You may need to enter the provided Bluetooth PIN on your phone.*



**STEP 10**  
Your smartphone is now paired with Entune.

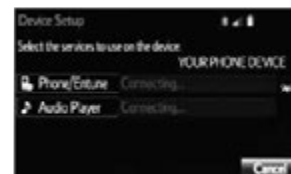

**STEP 11**  
Once paired, Entune will attempt to connect audio and contacts on your phone.

Initiate Bluetooth® on your Entune™ Multimedia Head Unit (continued)



**STEP 12**

Using your smartphone, you may need to allow Entune access to your contacts



**STEP 13**

A confirmation will appear that your phone has been paired and connected.

**Additional Resources**

If you're having trouble pairing your phone, Toyota has you covered. You can get more information from the following sources:

Online Pairing Guide:  
[www.toyota.com/connect](http://www.toyota.com/connect)

Your Toyota Owner's Manual  
*Located in the vehicle glovebox*

Toyota Customer Experience Center  
 (800) 331-4331

- Disclosures
- This brochure is accurate at the time of print; content subject to change based on periodic multimedia software updates.
1. Concentrating on the road should always be your first priority while driving. Do not use the hands-free phone system if it will distract you.
  2. The Bluetooth word mark and logos are registered trademarks owned by Bluetooth SIG, Inc. and any use of such marks by Toyota is under license. A compatible Bluetooth enabled phone must first be paired. Phone performance depends on software, coverage & carrier.
  3. Android is a trademark of Google, Inc. All rights reserved. Google is not a participant in or sponsor of this promotion.
  4. Apps/services vary by phone/carrier; functionality depends on many factors. Select apps use large amounts of data; you are responsible for charges. Apps & services subject to change. See Toyota.com/entune for details.
  5. Bluetooth Pairing Guide for select 2015 models.

